

*Refractory  
in Perfection*

**VGT-DYKO** 



*kiln furniture*

Already since many years VGT-DYKO is delivering kiln furniture for different industries.

Our business activities include next to saggars and supports also beams, variable and interchangeable systems, slabs, base supports and customized special-shape-bricks.

We produce our kiln furniture on hydraulic presses, handramming, vibro-pressed and also vibro-cast and slip cast.

A collection of our products is shown in this brochure. The mentioned dimensions are only as orientation. Especially the variance and flexibility of all dimensions is one of our strong points.

We are pleased to produce customized products in size, shape and material.

Please contact us for your individual necessity and application.

## Content

- 1) saggars*
- 2) system variable and interchangeable*
- 3) support*
- 4) triangle support*
- 5) connection plate*
- 6) slabs*
- 7) beam*
- 8) electro-porcelain construction*
- 9) supports for washbasin*
- 10) Base support*

## Our material for kiln furniture

*cordierite* (Cordierit)  
*silimanite* (Silidur)  
*mullite* (Mullidur)  
*silicon carbide* (SICA)

brand	character	temp in °C	SiO <sub>2</sub> in %	Al <sub>2</sub> O <sub>3</sub> in %	Fe <sub>2</sub> O <sub>3</sub> in %	ZrO <sub>2</sub> HfO <sub>2</sub> in %	Cr <sub>2</sub> O <sub>3</sub> in %	SiC in %	SiON in %	bd g/cm <sup>3</sup>	ap in %	ccs N/mm <sup>2</sup>	cbs N/mm <sup>2</sup>	tsr	te %	thermal conductivity W/mK				
																1000°C	400°C	800°C	1000°C	1200°C
SICA 70	SK70AM	1500						70		2,50	17	70		very good	0,45	8,03	6,16	5,25	4,33	
SICA 95 AN	SK95AN	1550						88	7	2,70	11	140		very good	0,58			16,00		
SICA 90/120/4	SK90DY	1600						90		2,60	15	90		very good	0,45	16,70	13,30	12,00	10,70	
SICA 90/4	SK90DC	1520						90		2,60	15	80	20	very good	0,40	16,70	13,30	12,00	10,70	
SICA 90/130/4K	SK90ED	1500						90		2,60	15	90		very good	0,40	16,70	13,30	12,00	10,70	
SICA 90/130/4	SK90EI	1500						90		2,60	15	90		very good	0,40	16,70	13,30	12,00	10,70	
SICA 90/110/7	SK90DO	1520						90		2,60	15	90	20	very good	0,40	16,70	13,30	12,00	10,70	
SICA 90/120/7	SK90EA	1600						90		2,60	15	90		very good	0,40	16,70	13,30	12,00	10,70	
SICA 90/7	SK90DB	1500						90		2,55	18	90	20	very good	0,40					
SICA 90/110/4	SK90DM	1500						90		2,55	18	90	20	very good	0,40			12,00		
Silidur 60 MW	SL60AW	1600	36	61	1					2,40	18	60		g to vg	0,60	1,71	1,73	1,74	1,75	
Silidur 60 S	SL60AS	1620	35	62	1					2,45	16	80		very good	0,60	1,71	1,73	1,74	1,75	
Silidur 60 AY	SL60AY	1600	36	61	1					2,50	17	80	20	good	0,60	1,71	1,73	1,74	1,75	
Silidur 80 AD	SL80AD	1800	19	80	0,5					2,70	19	80	10	good	0,60	2,18	2,08	2,03	1,98	
Mullidur 63	MU63HA	1600	32	64	0,7					2,50	19	80		g to vg	0,60	1,99	1,96	1,95	1,94	
Mullidur 63 HB	MU63HB	1800	32	64	0,7					2,50	18	90		g to vg	0,60	1,99	1,96	1,95	1,94	
Mullidur 80BR	MU80AB	1800	12	86	0,2					2,80	18	70	7	good	0,60	2,20	2,10	2,00	1,95	
Mullidur 80K	MU80AK	1750	16	82	0,5					2,60	18	70	10	good		1,99	1,96	1,95	1,94	
Mullidur 85AB	MU85AB	1800	15	84	0,2					2,80	18	70	10	good	0,60	2,20	2,10	2,00	1,95	
Cordierit M10G	CS37RA	1280	45	36,0	1,6					1,90	23	60	8	very good	0,40			1,35		
Cordierit M9	CS37AB	1280	52	37,0	1,5		6,5% MgO			1,90	23	35	15	very good	0,40			1,35		
Cordierit K78	CS37AE	1280	52	37,0	1,5		6,5% MgO			2,00	21	50	13	very good	0,40			1,35		
Cordierit M9	CS37AF	1320	52	37,0	1,5		6,5% MgO			1,90	23	35	15	very good	0,40			1,35		
Corit S115	CS25AA	1150	90	5,0						1,85	18	45	6	very good	0,25			2,08		

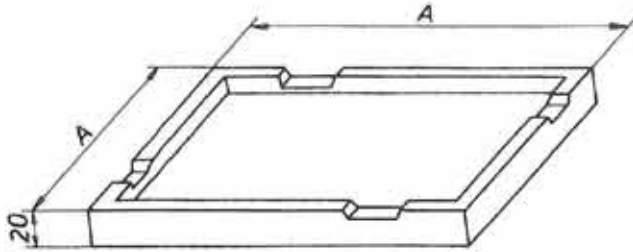

*floor-tile saggar*

*saggar with cover*



*open saggar*

*U-saggar*

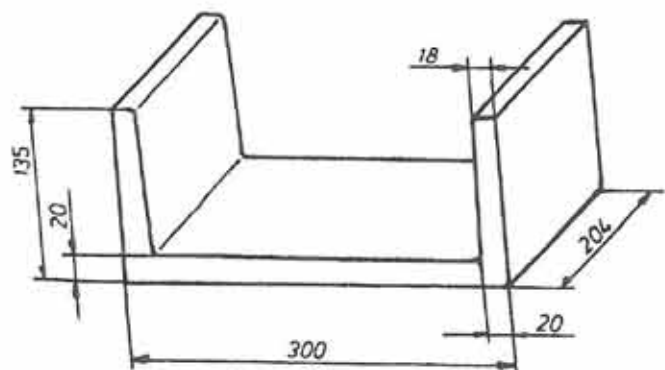

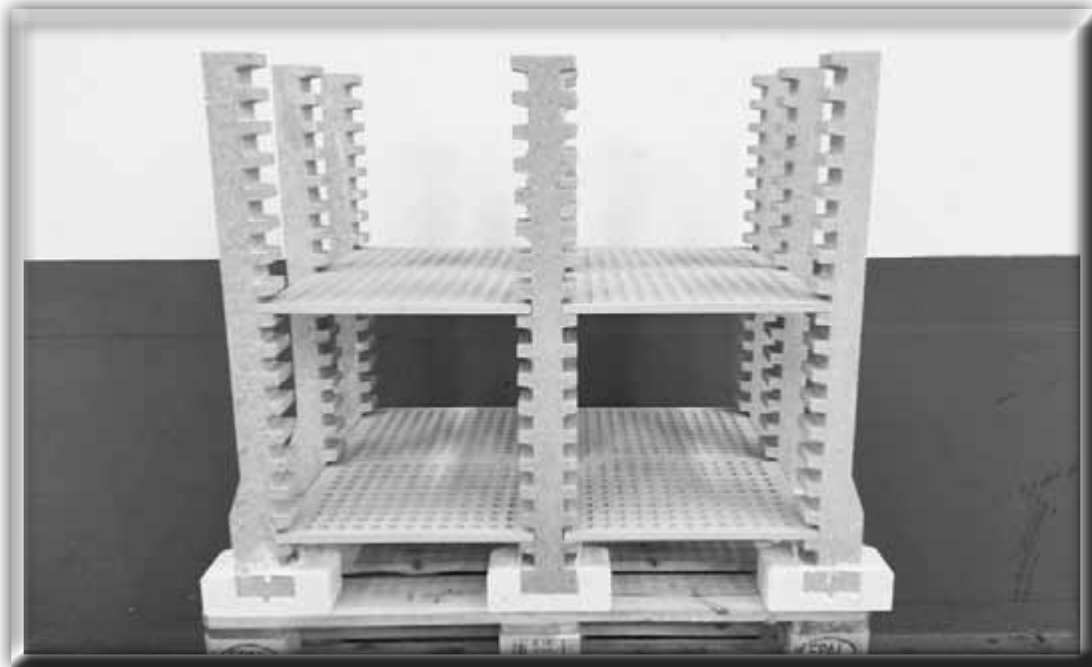

*system variable and interchangeable  
with / without bottom  
with / without cam  
1- or 2- sided*

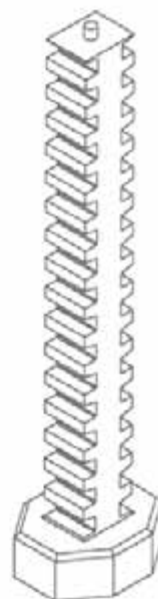
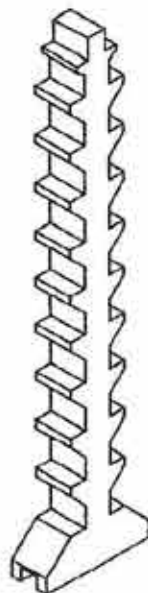
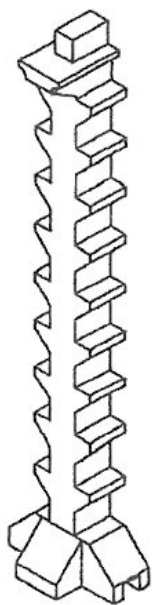

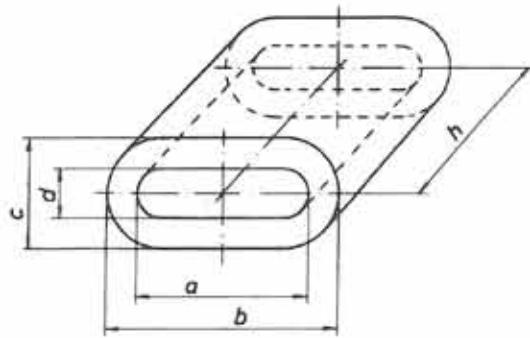

*ovalsupport*

*cylindric support*

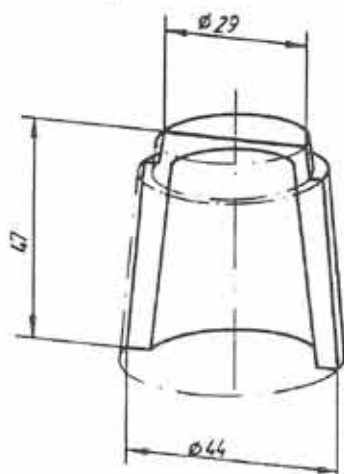
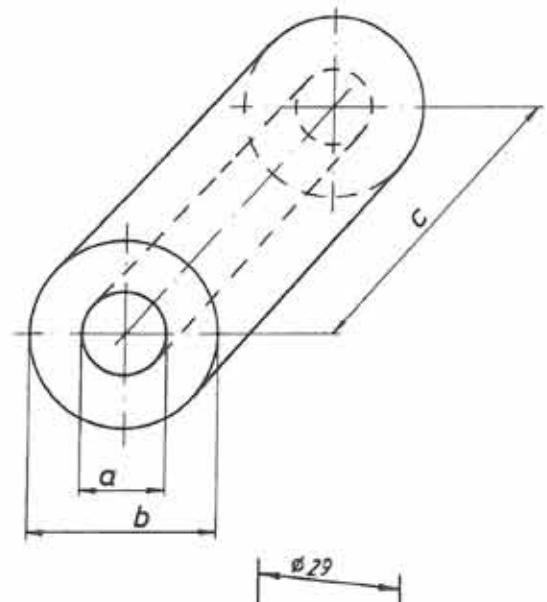

*stack support*

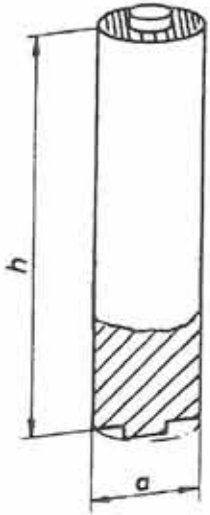

*cam support*

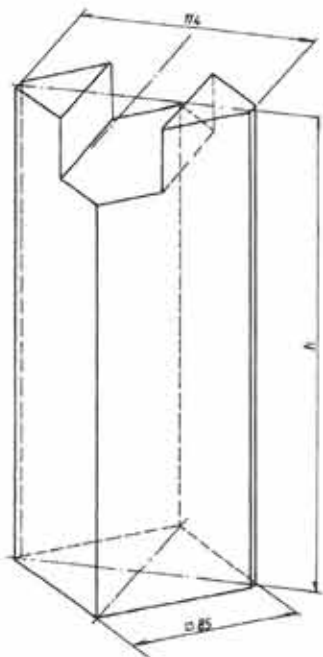
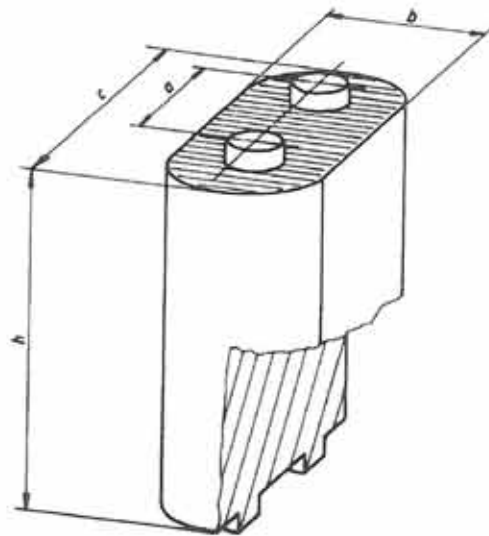

*beam support*

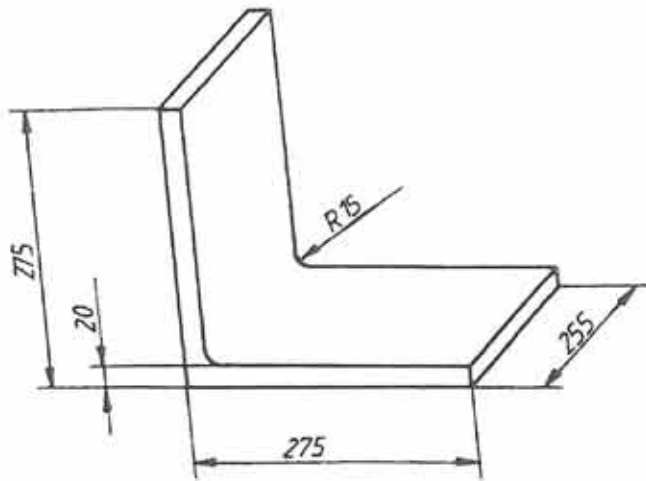

*triangle support*

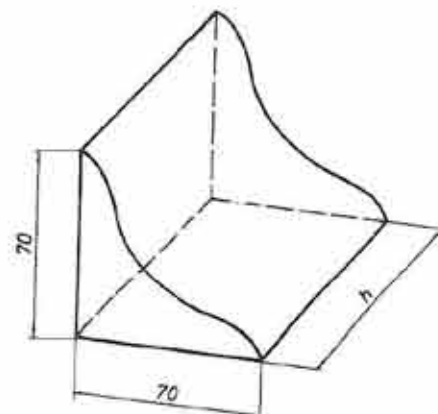
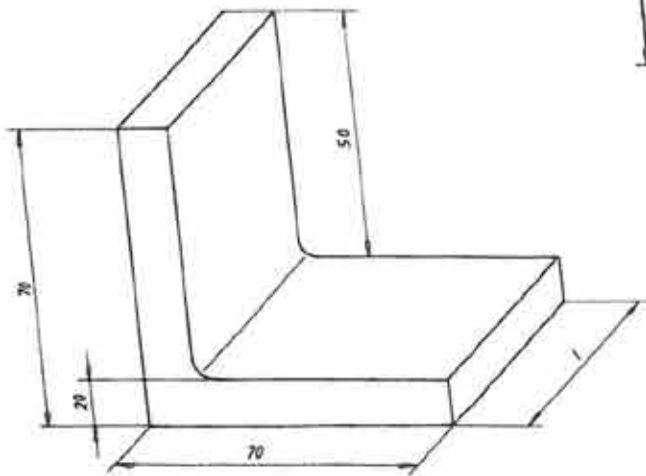
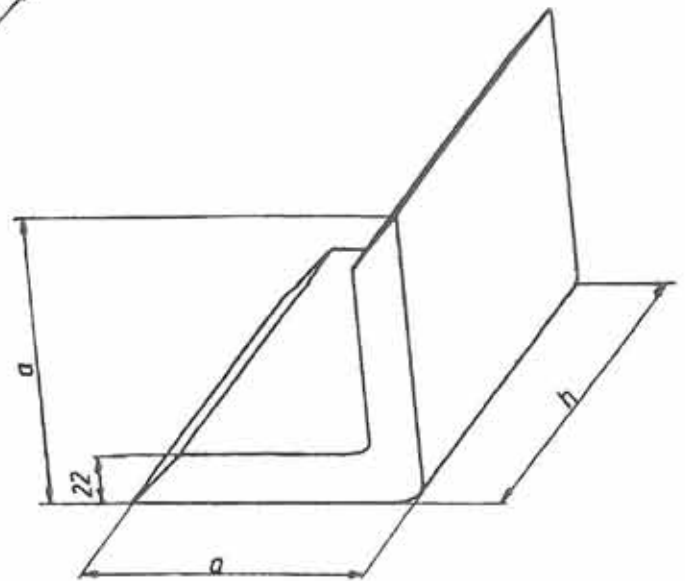

# connection plate

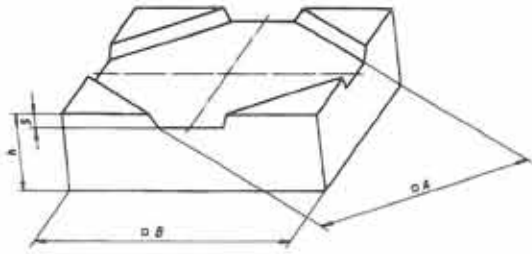

*connection plate*

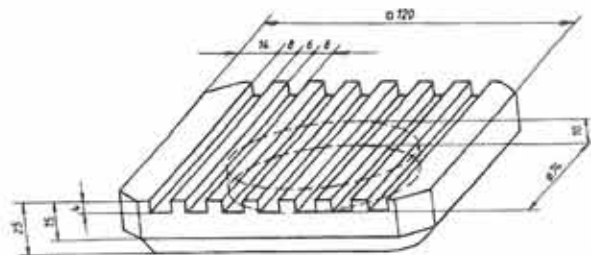
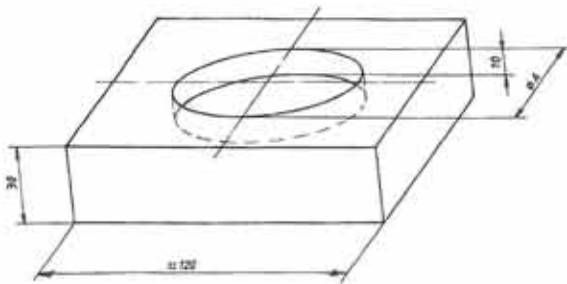
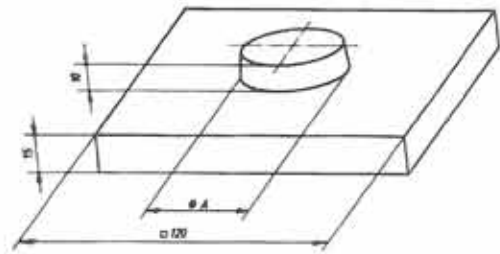



*ribbed slab*



*perforated slab*



*shaped slab*

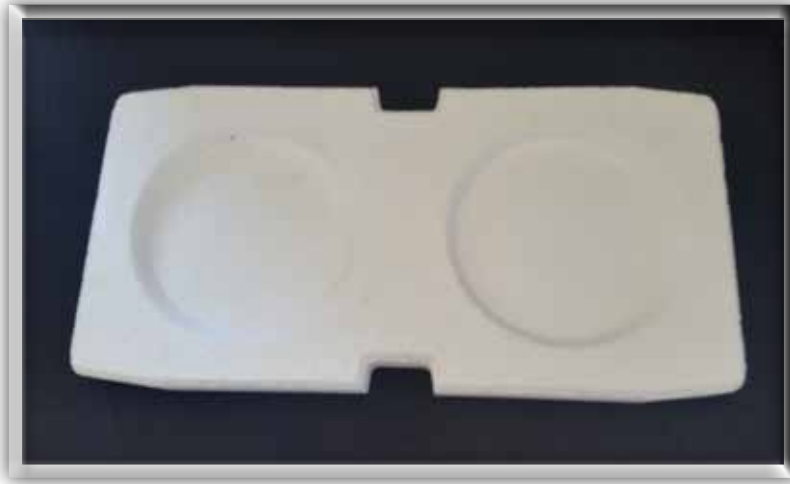

*push slab*

*disk*

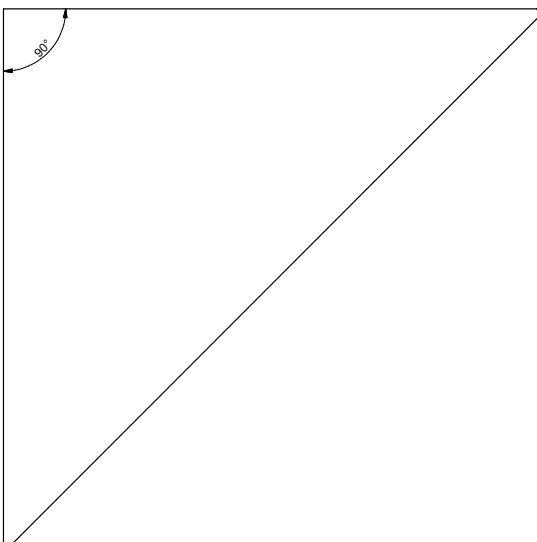
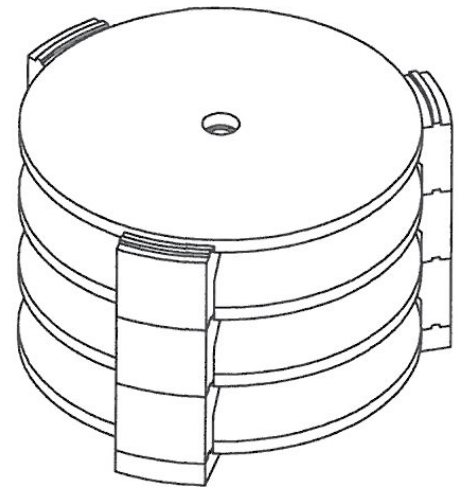

*triangle slab  
with / without rabbet*

*simple slabs (without picture)*

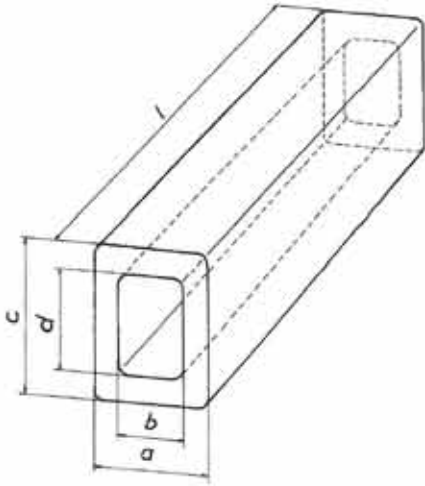

***hollowbeam***

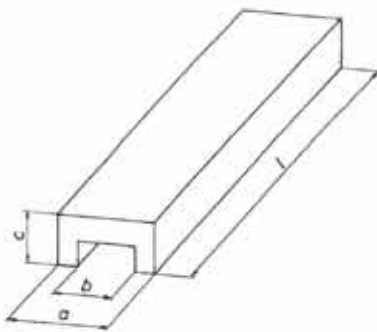
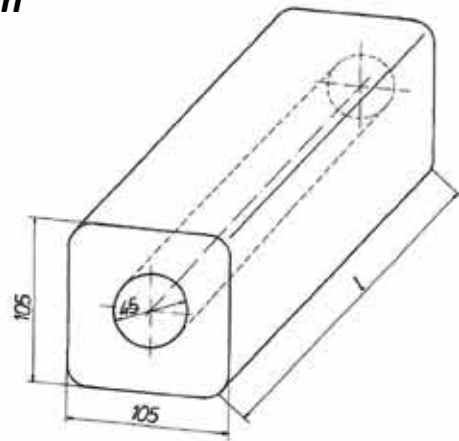

***U-beam***

***U-beam with support***

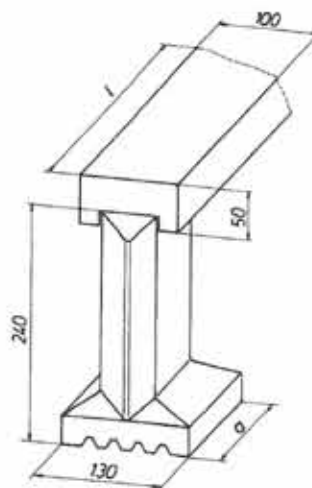

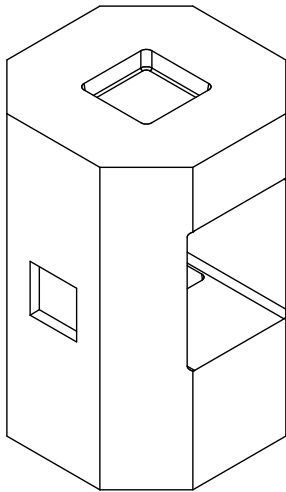

*column foot*

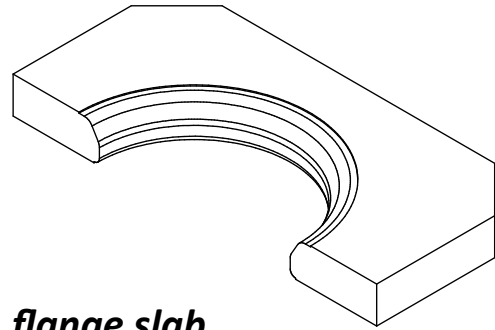

*flange slab*

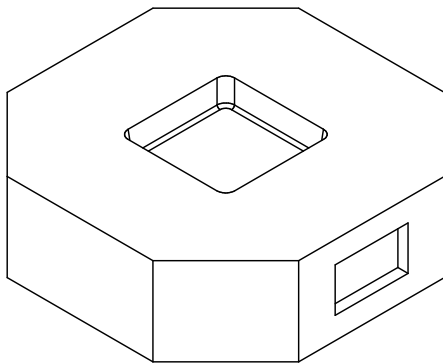

*sandwich plate*

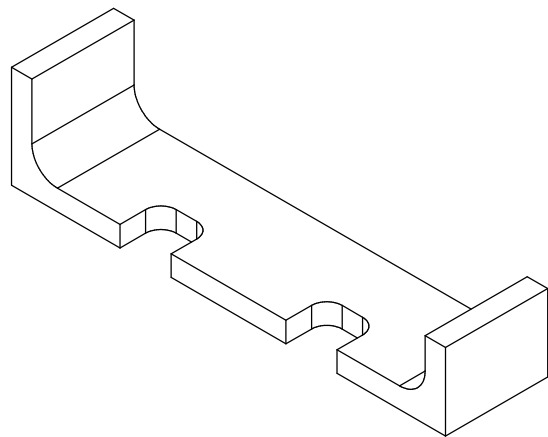

*bowl*

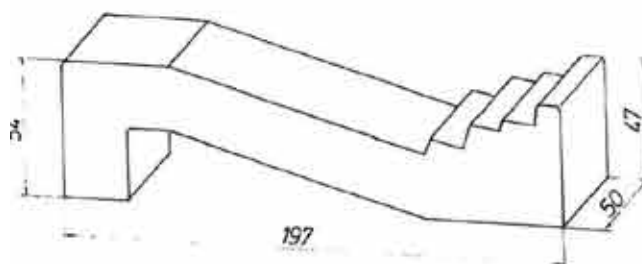

*supports for washbasin*

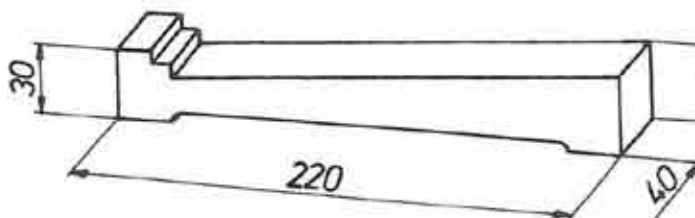

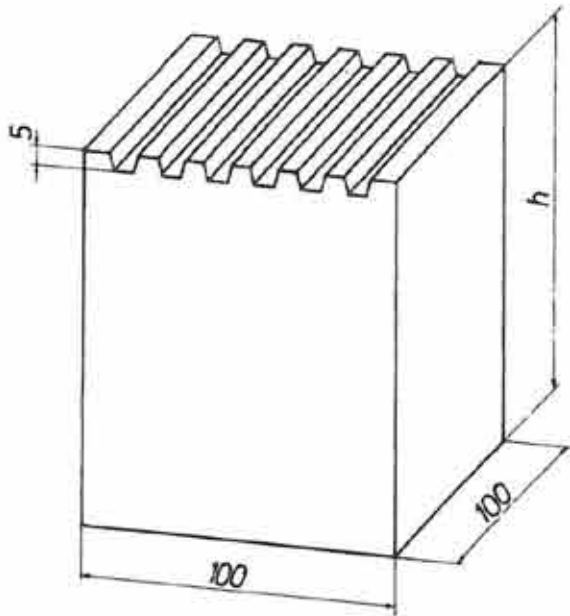

*base support*

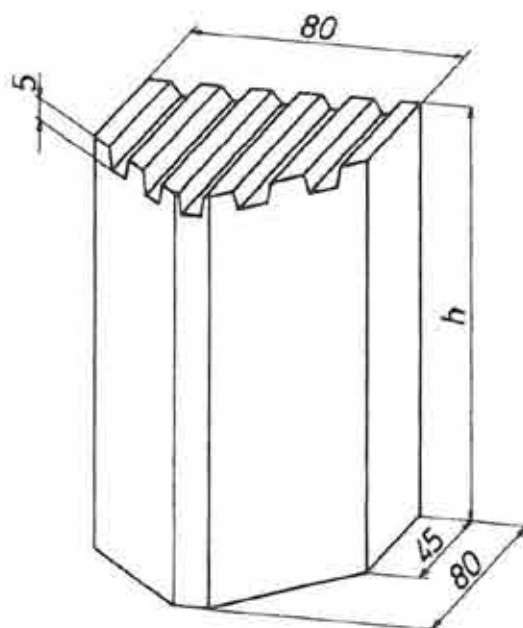

**VGT-DYKO** 

*Refractory  
in perfection*

**VGT-DYKO GmbH**

Grossalmeroder Straße 18  
D-37247 Grossalmerode

Tel.: +49(0)5604 934 0

Fax: +49(0)5604 934 289

E-Mail: [info@vgt-dyko.com](mailto:info@vgt-dyko.com)

[www.vgt-dyko.com](http://www.vgt-dyko.com)

---

*kiln furniture*